

ASSEMBLY INSTRUCTIONS 10B, 11B, 10, & 11 TOOTH DRIVERS

| ITEM # | PART # | DESCRIPTION | NOTES: |
|--------|---------------|---|---|
| #1 | PC-1234 | Clutch Bolt | #1 – Apply a small amount of nanoceramic grease to bearing & inside diameter of driver, and shoulder of crank shaft. Recommended grease PMC P/N PC-7200 (not included). #2 - Use item 5 OR 5A (not both) to achieve proper end play of clutch on crank (cranks may vary in length). .030"-.050" recommended. |
| #2 | PC-3160 | 5/16 Lock Washer | |
| #3 | PC-7033 | Aluminum Stepped Clutch Washer | |
| #4 | PC-7035 | Clutch Key | |
| #5 | PC-7042 | 3/4" ID x 1 1/8" OD X .015 thick Thrust Washer *SEE NOTE #2* | |
| #5A | PC-7041 | 3/4" ID x 1 1/8" OD X .030 thick Thrust Washer *SEE NOTE #2* | |
| #6 | PC-7034 | 1 7/16" Spiral External Retaining Ring | |
| #7 | PM-134010/015 | Drum for Performance Precision 2 or 4 Prong Drivers | |
| #8 | PM-134**** | Performance Precision ** Tooth 2 or 4 Prong Driver with Bearing | |

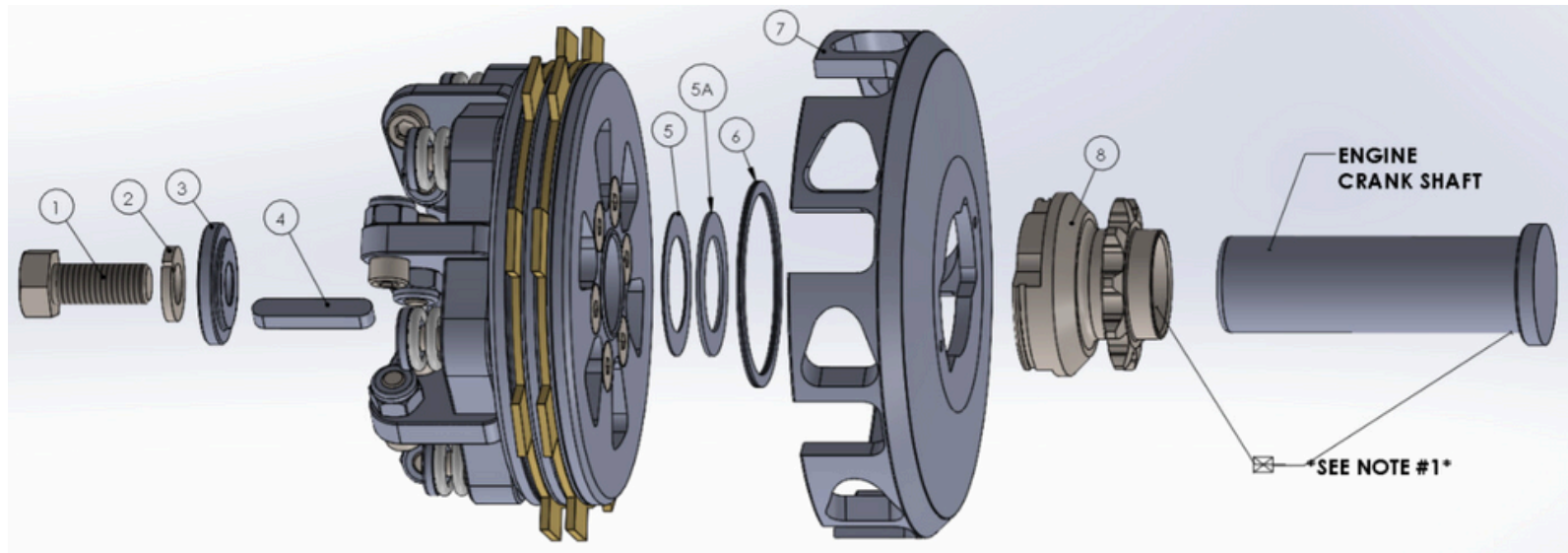

ASSEMBLY INSTRUCTIONS 12-20 TOOTH DRIVERS

| ITEM | PART # | DESCRIPTION | ITEM | PART # | DESCRIPTION |
|------|-----------|--|------|------------|--|
| #1 | PC-1234 | Clutch Bolt | #7 | PM-134095 | 22mm x 26mm Driver Bushing |
| #2 | PC-3160 | 5/16 Lock Washer | #8 | PM-134**** | Performance Precision ** Tooth 4 Prong Driver |
| #3 | PC-7033 | Aluminum Stepped Clutch Washer | #9 | PC-5114 | 22mm ID x 26mm OD x 17mm Long Cage Assy & Roller Bearing |
| #4 | PC-7035 | Clutch Key | #10 | PC-7040 | .88 ID x 1.10 OD x .030 Thick Thrust Washer |
| #5 | PC-7032 | 1 1/2" Spiral External Retaining Ring | #11 | PC-7031 | 7/8" Spiral External Retaining Ring |
| #6 | PM-134015 | Drum for Performance Precision 4 Prong Drivers | | | |

